

MP XRAYCER

In-service Summary

The operator should read and understand the MP XRAYCER, PURIST, and IOT accessory user manuals before using this equipment.

Overview

The MP XRAYCER can be used with the PURIST Leg Positioning System to improve surgical access to the acetabulum and allows x-ray cassettes to be used. Cutouts under the hips allow for soft tissue fall out, simplifying the reaming process and cup installation.

OR Table Setup

Follow all requirements of the OR table. Set up the OR table so that the patient's center of gravity is over the long portion of the table base for maximum stability. This can be achieved by translating the bed or flipping the table orientation 180°. Refer to the OR table user manual for setup configurations and weight limits.

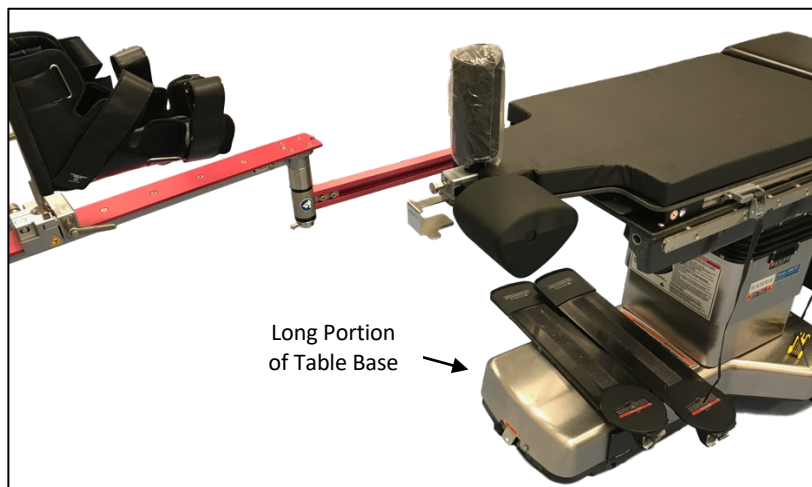

Figure 1: MP XRAYCER Setup (OR table shown flipped 180°)

Opposite Leg Holder (OLH)

The OLH used with the MP XRAYCER is slightly different than the OLH used without the MP XRAYCER:



Standard OLH	
OLH for use with MP XRAYCER	 <p>Taller Rotation Axis</p> <p>Longer Extension Rail</p>

Figure 2: OLH Variations

Ensure the OLH is configured for use with the MP XRAYCER.

1. If the OR table is in the standard orientation, remove the leg section(s) and attach the OLH to the middle section of the OR table.
2. If the OR table orientation is flipped 180°, remove the head section and attach the OLH to the middle section of the OR table.

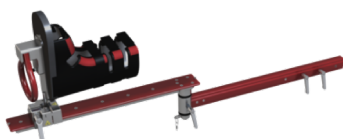
MP XRAYCER Positioning

Remove OR table cushions. Place the MP XRAYCER on the OR table as shown in Figure 1. The edge of the OR table should align with the red line shown in Figure 3.

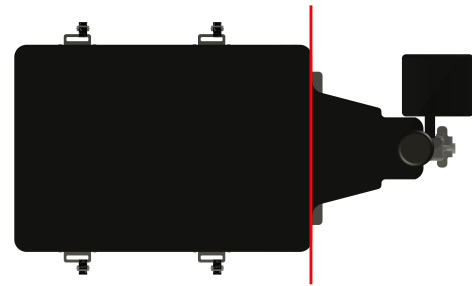

Figure 3: MP XRAYCER Positioning

MP XRAYCER Mounting

All OR tables are different – make sure to properly fix the MP XRAYCER to the OR table used. The following shows an example of how it can be done.

Four straps secure the MP XRAYCER to the OR table. Each strap can be moved by loosening the screws (1) with a 4mm hex key, sliding the attachment (2), then re-tightening these screws. The attachments should be positioned above the side rail mounts (3) when possible, with the strap proximal (cephalad) to the mount.

Each attachment can be moved between the two stop screws (4). For simplest setup compatible with most OR tables, move each of the four attachments as far up (cephalad) as possible. This allows for maximum Opposite Leg Holder (OLH) engagement. Secure each strap as shown below. The thickest part of the strap (with the stitched X) should be positioned behind (medial to) the attachment. To tighten the strap, pull straight down on the excess strap hanging below the metal clasp. Make each strap as tight as possible to resist movement.

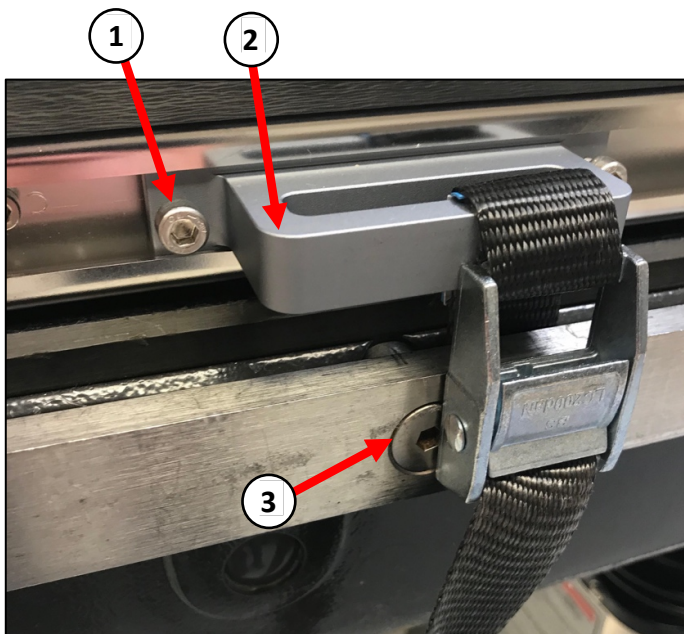

Figure 4: Strap Positioning

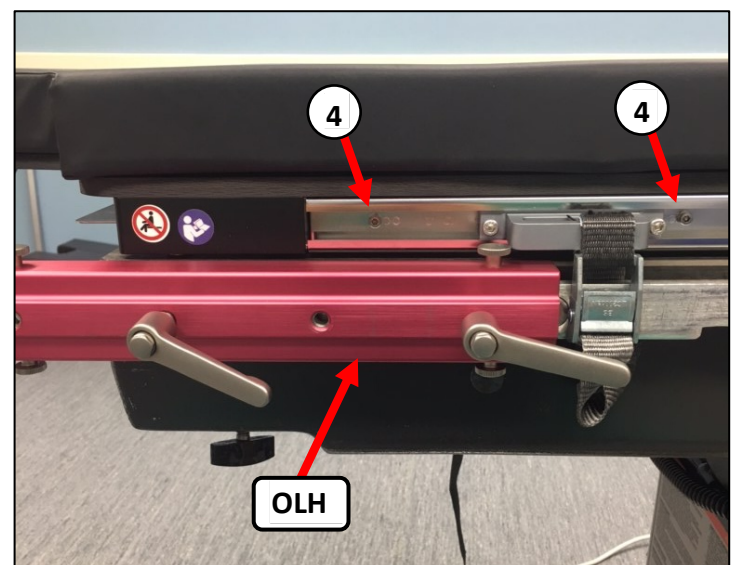

Figure 5: Strap Positioning near OLH

Final Assembly

Ensure the cushion is attached and correctly aligned to the MP XRAYCER using the Velcro attachments. For taller patients, use pads beyond the MP XRAYCER to support the patient's head. Ensure the pads beyond the MP XRAYCER match the height of the MP XRAYCER pad.

Install the perineal post and femoral support. The perineal post simply slides into the holder on the MP XRAYCER. To install the femoral support (6), pull the pin (5), push the femoral support into the holder, then release the pin. Install the femoral support on the operative side.

The femoral support has four height settings. To change the height setting, pull the pin, remove the femoral support, rotate to the desired height setting, push the femoral support back into the holder, and release the pin. Height setting dependent on surgeon preference.

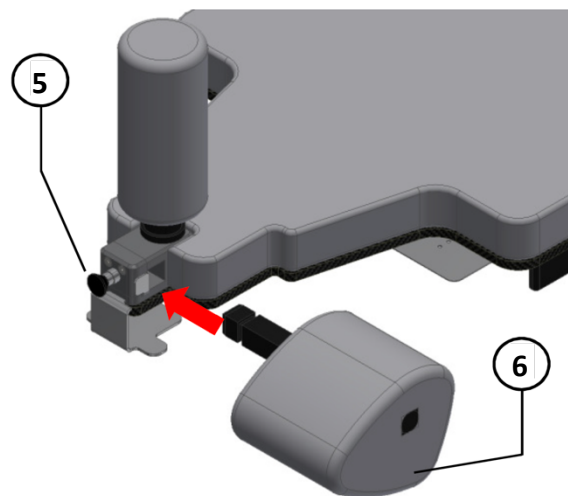

Figure 6: Femoral Support Installation

X-Ray Cassette Usage

To insert an x-ray cassette, first remove any operative leg extension, then remove the femoral support. Press the locking lever (7), pull out the cassette holder (8) as far as possible, insert the x-ray cassette (9) from the side, then push the cassette holder back in. When removing the x-ray cassette, hold it with one hand while opening the x-ray cassette holder.

Temporarily flexing or lifting the operative leg can make it easier to reinsert the femoral support.

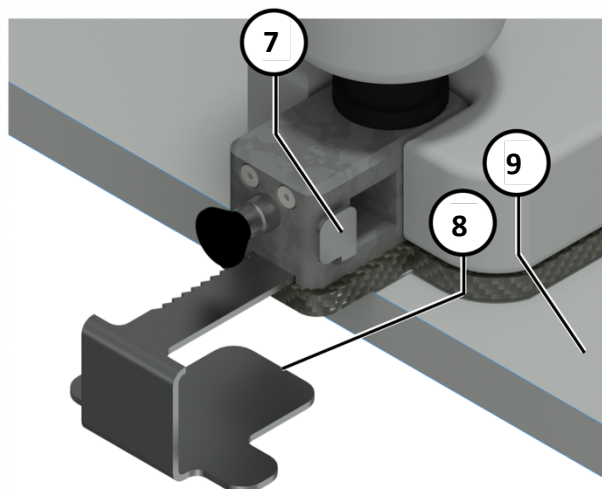

Figure 7: X-Ray Cassette Holder

Weight Limit

The MP XRAYCER is designed for a maximum patient weight of 227 kg (500 lbs.). This weight limit is also dependent on the OR table weight limit.

Maintenance and Storage

Clean the device after each case and store it on the back of the PURIST. Replace perineal post and femoral support pads after approximately ten surgeries.